

TRC0401 - SWING AWAY CHIN CONTROL

REVISION: 05/13/2008

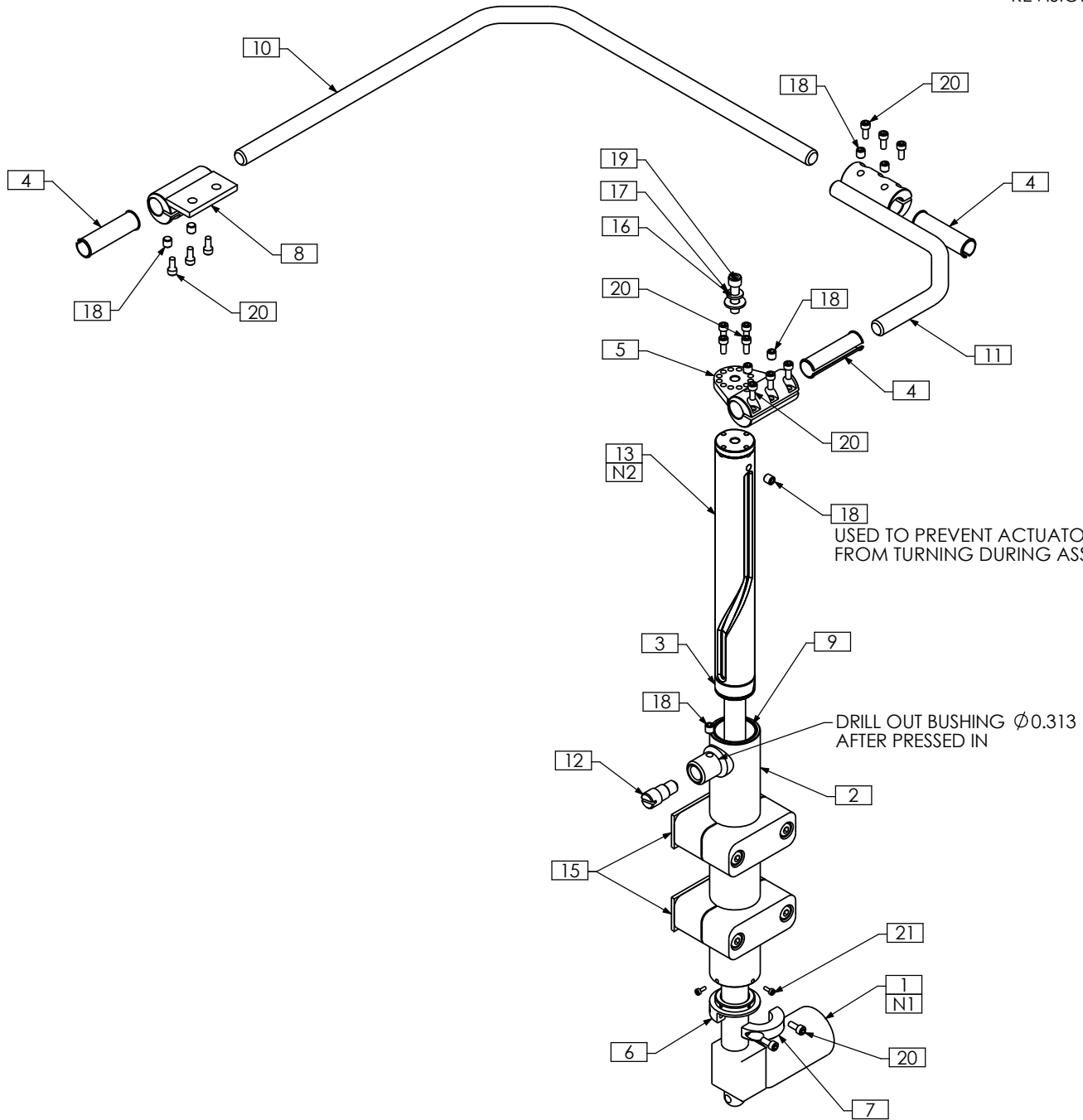

NOTES:
 1. ALUMINUM ACTUATOR BARREL TO BE MODIFIED AS PER TRX2305
 2. ASSEMBLE UP THROUGH THE BOTTOM OF THE CAM HOUSING - BEFORE ACTUATOR.
 RIGHT-HAND VERSION SHOWN
 3. SHOWN AS IS FOR BILL OF MATERIAL PURPOSES ONLY

ITEM NO.	QTY.	PART NO.	DESCRIPTION	ITEM NO.	QTY.	PART NO.	DESCRIPTION
1	1	TRX2305	7" ACTUATOR BARREL MODIFICATION	12	1	TRX4237	CAM PIN
2	1	TRX2088	CYLINDER WLD	13	1	TRX4811	CAM WLD
3	1	TRX2090	CYLINDER CAM RING	14 N/S	1	TRM0464	SYL-GLIDE, PACKET
4	3	TRX2099	CLAMP BUSHING	15	2	TRM0485	PIPE CLAMP, 1½", STAUFF No. - SP 538-PP IS
5	1	TRX2100	CONTROL ARM BRACKET WLD	16	1	TRH0101	¼" FLAT WASHER
6	1	TRX2224	ACTUATOR COLLAR	17	1	TRH0115	¼" LOCK WASHER
7	1	TRX2225	ACTUATOR CLAMP	18	8	TRH0336	SET SCREW, 0.25 x 0.25
8	1	TRX2226	CHIN CONTROL CLAMP WLD	19	1	TRH0350	¼-28 x 1" SOCKET HEAD CAP SCREW GR8
9	1	TRX2228	CAM HOUSING BUSHING	20	15	TRH0522	#8-32 x 3/8" SOCKET HEAD CAP SCREW GR8
10	1	TRX2229	CONTROL BAR	21	4	TRH0534	#4-40 x ¼" SOCKET HEAD CAP SCREW GR8
11	1	TRX2646	RECEIVER WLD	22 N/S	1	TRW0114	WIRING, SWING AWAY CHIN CONTROL