

A 3D rendered image of the MaTRx Headrest Installation hardware. It features a central vertical post. At the top, there is a horizontal arm with a circular headrest component. A rectangular mounting bracket is attached to the post below the headrest. At the bottom of the post, there is another rectangular mounting bracket with two circular fasteners. The entire assembly is rendered in a light gray color.

MaTRx Headrest Installation

***Multi-Axis
Mounting Hardware***



Installation Manual

MaTRx Headrests with Multi-Axis Mounting Hardware

HEADREST KITS:

The installation hardware/components provided in each **Multi-Axis Mounting Hardware Kit** are identical (refer to **Figure 1.0** below). There are **seven (7)** optional headrest assemblies available for use with our multi-axis mounting hardware. (Headrest Pad options are illustrated in **Figure 2.0**).

Multi-Axis Mounting Hardware (excluding headrest ass'y)

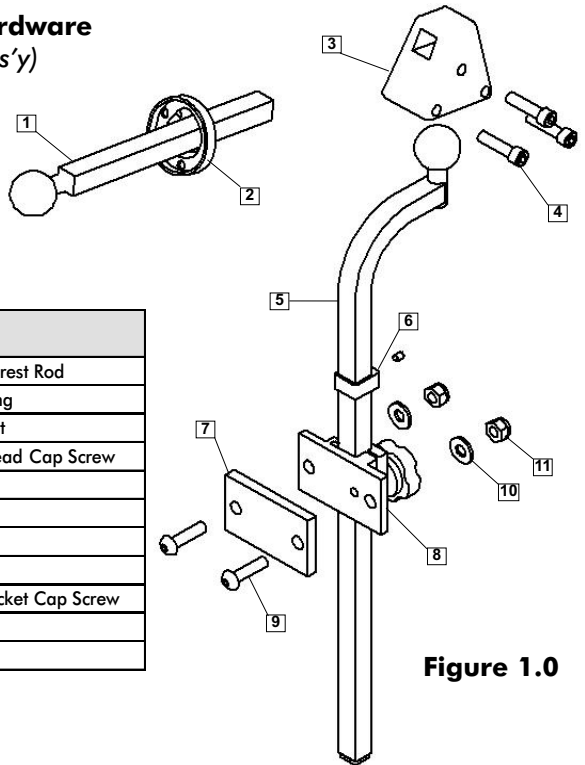

Item No	Qty	Description
1	1	Small Horizontal Headrest Rod
2	1	Headrest Mounting Ring
3	1	Triangular Multi -Offset
4	3	1/4-20 x 1" Socket Head Cap Screw
5	1	Vertical Headrest Rod
6	1	D-Ring (w/ set screw)
7	1	Shim
8	1	Headrest Clamp Ass'y
9	2	1/4-20 x 1" Button Socket Cap Screw
10	2	1/4" Flat Washer
11	2	1/4-20 Nyloc Nut

Figure 1.0

Headrest Kit Options: (refer to **Figure 2.0** for the various Headrest Assemblies)

Model/Kit No.	Description
SPSH-MAHU	Standard Pad / Hardware
OPSH-S-MAHU	Ottobock Pad / Hardware- small
OPSH-L-MAHU	Ottobock Pad / Hardware- large
STSH-N-MAHU	Stealth Pad / Hardware- nino
STSH-XS-MAHU	Stealth Pad / Hardware- extra small
STSH-S-MAHU	Stealth Pad / Hardware- small
STSH-L-MAHU	Stealth Pad / Hardware- large

*MAHU (Multi-Axis Hardware Upgrade)

MaTRx Headrests with Multi-Axis Mounting Hardware

Figure 2.0 - Optional Headrest Assemblies

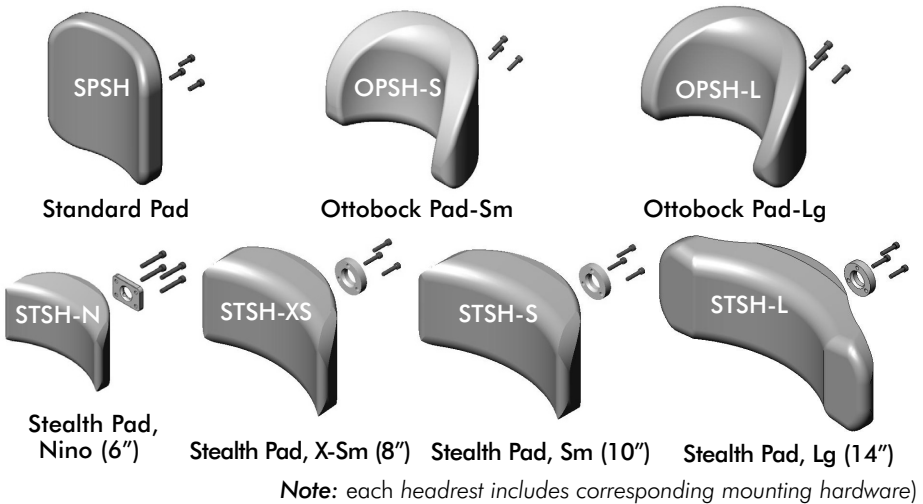

TOOLS REQUIRED:

Wrenches: 7/16"

Allen Key: 5/32", 1/8"

Phillips Screwdriver

Tape Measure/Ruler

Power Drill

1/4" Drill Bit

INSTALLATION INSTRUCTIONS:

The headrest clamp is secured to the wheelchair back using the hardware provided. Whenever possible, the clamp should be installed into existing mounting holes in the backpan. If no holes are provided, holes may be drilled in the desired location using the mounting plate as a template¹. An optional shim plate may be installed between the clamp ass'y and the back pan to provide additional clearance when needed.

The overall height of the headrest pad/ mounting post can be adjusted via the clamp assembly. (**note:** once the final height position is set, the D-Ring should be installed so that it rests flush with the top of the clamp assembly (*to prevent slipping*)).

The headrest pad is secured to the horizontal headrest rod via the mounting ring and the headrest hardware provided. (**note:** the headrest pad can be adjusted to any desired angle via the pivot ball at the end of the headrest rod by loosening and tightening the mounting hardware).

The headrest (*and horizontal rod*) can be further adjusted for depth and angle via the triangular multi-offset bracket. To make adjustments, loosen the the hardware in the multi-offset bracket, set headrest to the desired position and re-tighten hardware.

¹ Important! - before drilling/modifying any backpan, be certain to contact the back manufacturer to ensure the back is recommended to support a headrest application.

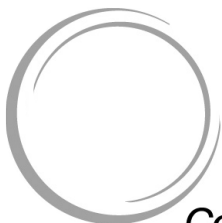

Motion Concepts

www.motionconcepts.com
info@motionconcepts.com

USA

700 Ensminger Rd. Suite 112
Tonawanda, NY 14150
Toll Free Tel: 1.888.433.6818
Toll Free Fax: 1.888.433.6834

Canada

84 Citation Drive
Concord, Ontario L4K 3C1
Toll Free Tel: 1.866.748.7943
Tel: 905.695.0134
Fax: 905.695.0138

