



**MaTRx  
Headrest  
Installation**

***Worlds Best  
Mounting Hardware***



**Installation Manual**

# MaTRx Headrests with the Worlds Best Mounting Hardware

## HEADREST KITS:

The installation hardware/components provided in each 'World's Best' Mounting Hardware Kit are identical (refer to **Figure 1.0** below). There are **seven (7)** optional headrest assemblies available for use with our multi-axis mounting hardware. (Headrest Pad options are illustrated in **Figure 2.0**).

Item No.	Qty	Description
1	1	Headrest Mounting Ring
2	1	Dual Link Pivot System
3	1	Triangular Multit-Offset
4	2	1/4-20 x 1" Socket Head Cap Screw
5	1	Vertical Headrest Post
6	1	D-Ring (w/ set screw)
7	1	Shim
8	1	Headrest Clamp Ass'y
9	2	1/4-20 x 1" Button Socket Cap Screw
10	2	1/4" Flat Washer
11	2	1/4-20 Nyloc Nut

## Worlds Best Mounting Hardware (excluding headrest ass'y)

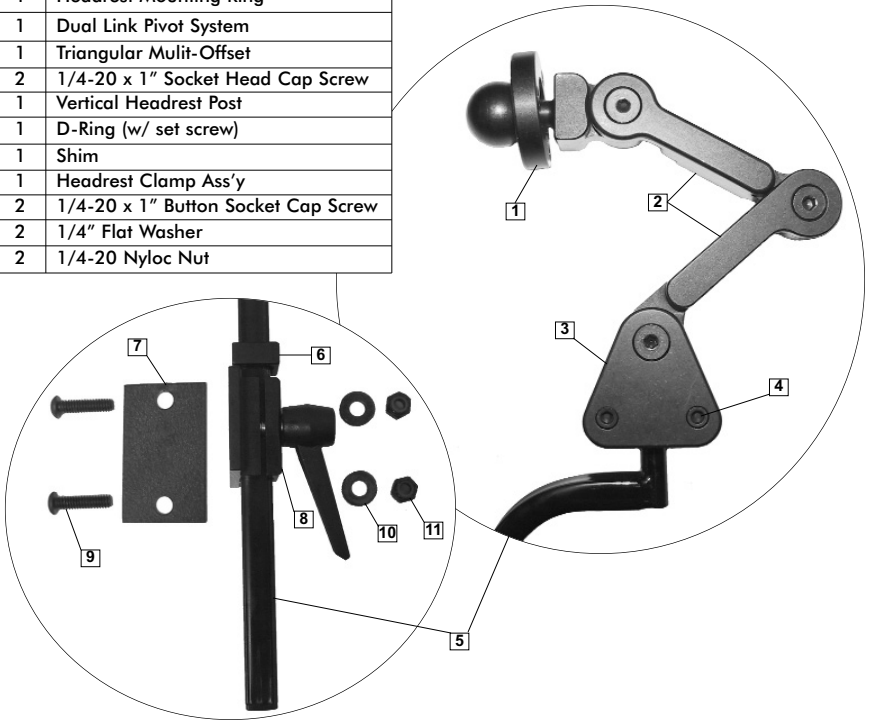

## Headrest Kit Options: (refer to **Figure 2.0** for the various Headrest Assemblies)

Model/ Kit No.	Description
SPSH-WBHU	Standard Pad/ Hardware
OPSH-S-WBHU	Ottobock Pad/ Hardware- small
OPSH-L-WBHU	Ottobock Pad/ Hardware- large
STSH-N-WBHU	Stealth Pad/ Hardware- nino
STSH-XS-WBHU	Stealth Pad/ Hardware- extra small
STSH-S-WBHU	Stealth Pad/ Hardware- small
STSH-L-WBHU	Stealth Pad/ Hardware- large

\*WBHU (Worlds Hardware Upgrade)

## MaTRx Headrests with the Worlds Best Mounting Hardware

**Figure 2.0 - Optional Headrest Assemblies**

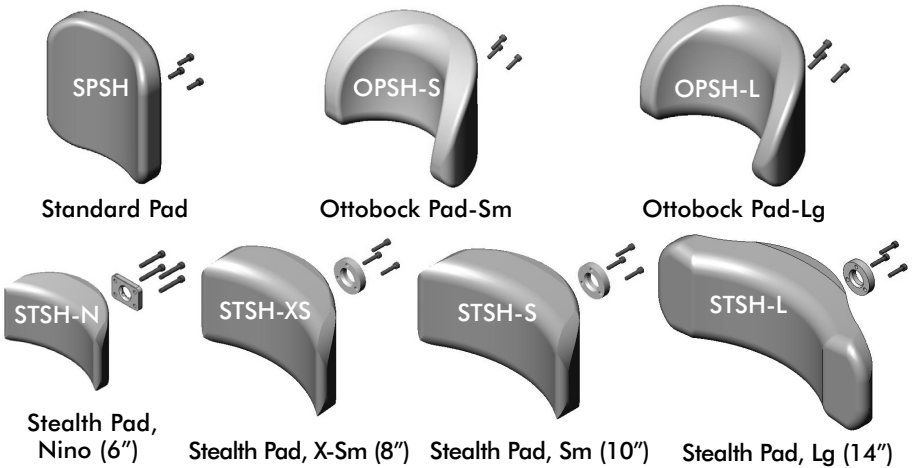

*Note: each headrest includes corresponding mounting hardware)*

### **TOOLS REQUIRED:**

Wrenches: 7/16"

Allen Key: 5/32", 1/8"

Phillips Screwdriver

Tape Measure/Ruler

Power Drill

1/4" Drill Bit

### **INSTALLATION INSTRUCTIONS:**

The headrest clamp is secured to the wheelchair back using the hardware provided. Whenever possible, the clamp should be installed into existing mounting holes in the backpan. If no holes are provided, holes may be drilled in the desired location using the mounting plate as a template<sup>1</sup>. An optional shim plate may be installed between the clamp ass'y and the back pan to provide additional clearance when needed.

The overall height of the headrest pad & vertical mounting post can be adjusted via the clamp assembly. (**note:** once the final height is set, the D-Ring should be installed so that it rests flush with the top of the clamp assembly (*to prevent slipping*)).

The headrest pad is secured to the dual link system via the mounting ring and the headrest hardware provided. (**note:** the dual link ass'y allows the headrest position to be adjusted to virtually any desired angle or depth by loosening & tightening the pivot screws; the headrest pad itself can be angle adjusted via the pivot ball at the end of the dual link ass'y).

The entire headrest assembly (*incl. dual links*) may also be adjusted to different angles via the triangular multi-offset bracket. To make adjustments, loosen the screws in the triangular bracket, set headrest to the desired position & re-tighten hardware.

**<sup>1</sup> Important!** - before drilling/modifying any backpan, be certain to contact the back manufacturer to ensure the back is recommended to support a headrest application.

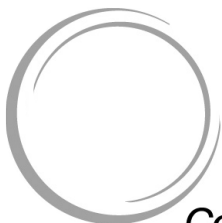

**Motion** Concepts

[www.motionconcepts.com](http://www.motionconcepts.com)  
[info@motionconcepts.com](mailto:info@motionconcepts.com)

**USA**

700 Ensminger Rd. Suite 112  
Tonawanda, NY 14150  
Toll Free Tel: 1.888.433.6818  
Toll Free Fax: 1.888.433.6834

**Canada**

84 Citation Drive  
Concord, Ontario L4K 3C1  
Toll Free Tel: 1.866.748.7943  
Tel: 905.695.0134  
Fax: 905.695.0138

